

MILK COOLING TANK with ICE WATER COOLING REM/DIB 3800 - 15000 l



Dairy Cooling Solutions
A Division of Eurotec Limited

Packo

Characteristics

- › Horizontal tank with laser welded efficient evaporator
- › Constructed of stainless steel 18/10 – AISI 304
- › Chassis with solid leg construction and adjustable feet (standard 2 % slope)
- › Flat manhole and swivelling cover with rubber seal
- › Detachable air vent
- › 2 milk inlet openings, 80 mm (1 in the manhole cover, 1 at the back)
- › Tank outlet Ø 80 mm, self washing outlet with butterfly valve Ø 65 or 80 mm and road tanker connection NW 50 or 65 (other milk road tanker connections on request, e.g. SMS, DS, RJT or IDF)
- › "Self washing outlet" easy to upgrade (no welding). Increased second hand value.
- › All models are fitted with a stainless steel ladder
- › Tank conform EN 13732 standard - KEYMARK

Tank control and display

- › All electrical tank components 1 ~ 230V – 50Hz (other voltages / frequencies on request)
- › Milk temperature control with electronic operating unit iControl
- › Digital temperature indication with large LCD display
- › Deep cooling (1.9 °C)
- › Two adjustable set points (3.2 °C and 4.5 °C)
- › Full automatic logging of cooling, cleaning and errors
- › Possible to cool and dose manually

Cooling and agitation

- › All the benefits of cooling with ice water apply
- › A separate ice builder provides the ice water
- › Very fast cooling with no risk of freezing even the smallest quantities of milk
- › A high cooling capacity is guaranteed
- › The number of agitator motors depends on the volume of the tank (see table tank dimensions)



Cleaning

- › 2 automatic dosage pumps for detergents
- › Automatic water level control for optimal filling and low water usage
- › High pressure dynamic Packo-ROTOJET system with spray balls in agitator blade(s)
- › Vertically mounted stainless steel cleaning pump, no risk of freezing
- › Pump power: 1,5 kW, 1 ~ 230V 50Hz

Available options

- › Calibration
- › Warning messages sent by SMS
- › Bottom filling
- › OCULUS tank guard to monitor all tank functions
- › PACAP digital volume indication with LED
- › Tank adapted to AMS milking
- › ECO-WASH cleaning
- › Second draining valve
- › Third dosage pump
- › Detection empty cleaning product
- › Inline heating cleaning water
- › Flow meter alkaline detergent

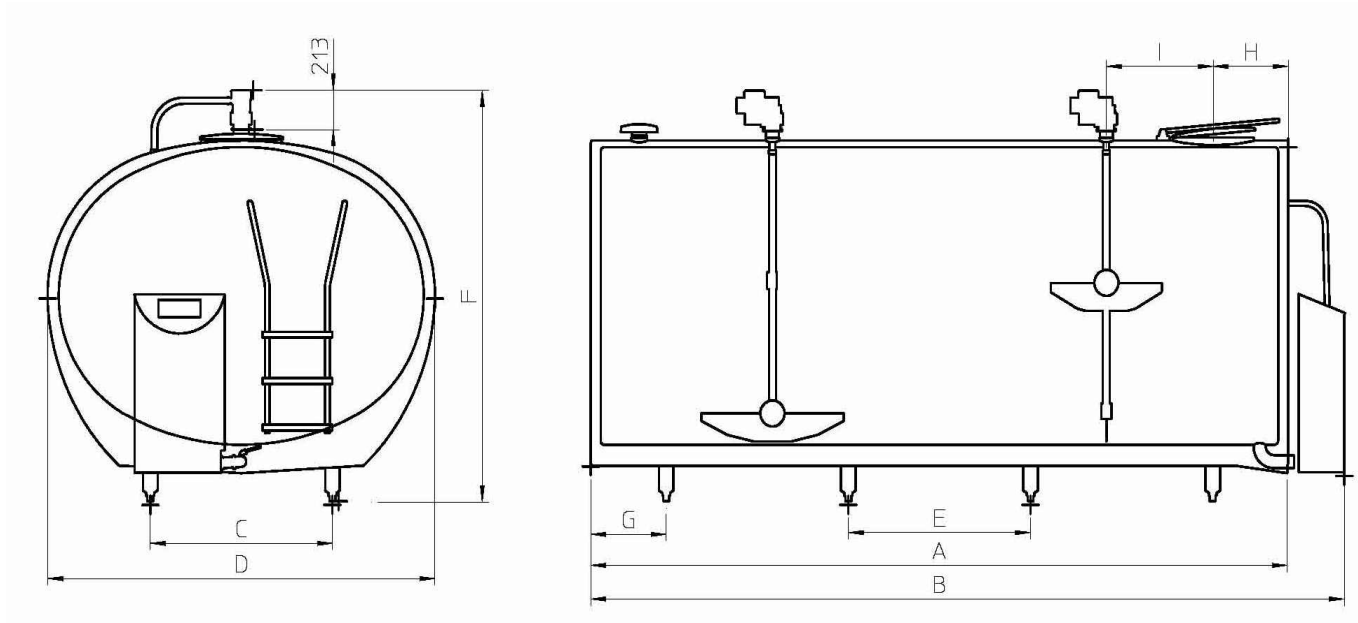

REM/DIB Dimensions

Model	Max. cap. litres	A mm	B* mm	C mm	D mm	E mm	F** mm	G mm	H mm	I mm	Legs number	Weight kg
3800	3944	2503	2854	934	1800	1690	1840-1960	402	431,5	820	4	590
4400	4562	2873	3224	934	1800	1050	1840-1960	382	431,5	1005	6	667
5000	5128	3213	3564	934	1800	1210	1840-1960	392	431,5	1175	6	730
RS 5000	5102	2380	2731	1050	2100	1580	2058-2178	400	426,5	758	4	750
6150	6321	2893	3244	1050	2100	1050	2058-2178	392	431,5	1015	6	854
7200	7369	3354	3705	1050	2100	1210	2058-2178	462	431,5	1245	6	901
RS 8000	8159	3140	3491	1050	2233	870	2208-2328	259	431,5	1138	8	1065
8200	8406	3809	4160	1050	2100	1050	2058-2178	324	431,5	555,5	8	1090
9000	9566	3681	4032	1050	2233	1050	2208-2328	260	431,5	531	8	1160
10000	10482	4011	4362	1050	2233	1050	2208-2328	425	431,5	616	8	1229
12000	12602	4810	5161	1050	2233	1050	2208-2328	305	431,5	812	10	1450
15000	15762	5986	6337	1050	2233	1050	2208-2328	368	431,5	1113	12	1800

*With ECO-WASH: B + 190 mm.

**With tank guard Oculus: F + 25 mm.

F = min. and max. height of leg screw when tank is installed completely horizontal

Available in 2, 4 & 6 Milkings and AMS milking.

REM/DIB 3800-5000: 1 agitator incorporating 1 ROTOJET spray ball.

REM/DIB 6150-8000: 1 agitator incorporating 2 ROTOJET spray balls.

REM/DIB 8200 - 15000: 2 agitators incorporating 4 ROTOJET spray balls.

Subject to modifications. The photographs and descriptions provided are intended as a guide and may not always exactly match the items supplied.



Dairy Cooling Solutions

A Division of Eurotec Limited

www.dairycoolingsolutions.nz

T: 09 579 1990

E: sales@eurotec.co.nz